

- FOOTINGS & SLAB:**
1. Penneater Stem Wall Footings: 20" Wide x 12" Deep with
 2. #5 continuous.
 3. - #5 continuous.
 4. Provide 4" thick concrete slab with 6x6 1/0/10 WMM on 6 mil vapor barrier over 95% density clean compacted fill.
 5. Install 1 - #5 Continuous at top of Stem Wall at slab level.
 6. All concrete in footings & slabs shall be 3000 psi.
 7. Lap reinforcing shall be 40 Grade min.
 8. Lap reinforcing 24" min.

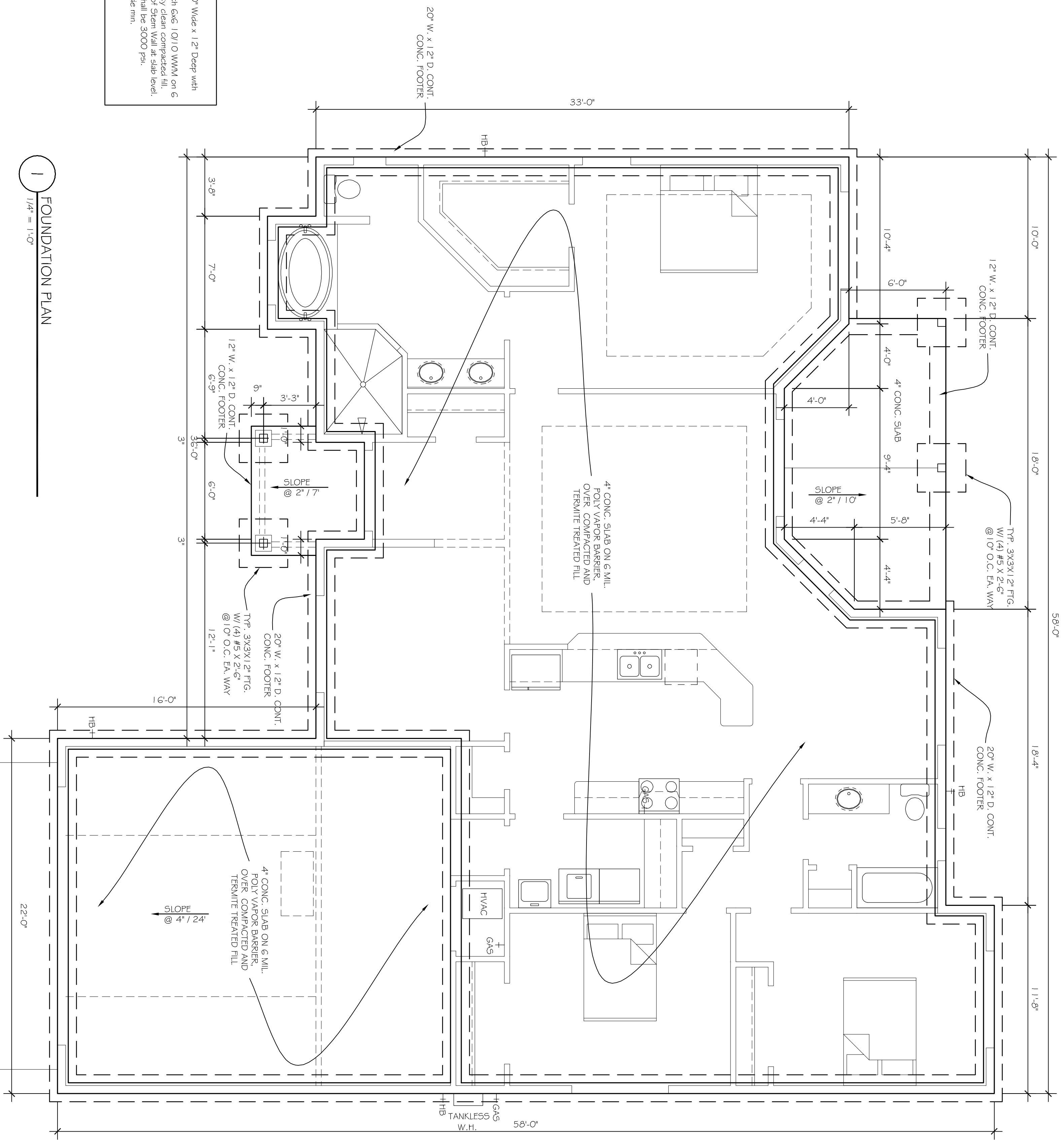

1 FOUNDATION PLAN
1/4" = 1'-0"

All construction shall comply with the Florida Building Code (Edition 5), National Electrical Code (2014), NFPA 101 Life Safety Code w/ Florida Modifications, and Florida Fire Prevention Code.